

MTS  
YOKE

Instruction Manual  
Bedienungsanleitung  
Mode d'emploi

# PARTS

[dimensions in mm / different scales]  
No extra or spare parts listed!

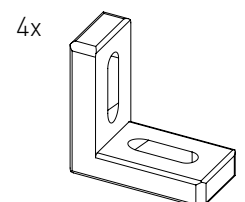
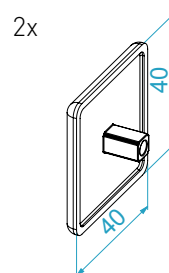
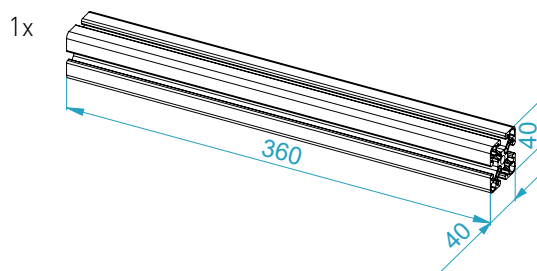
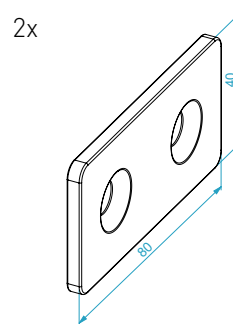
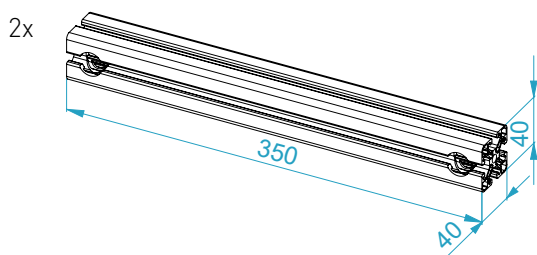
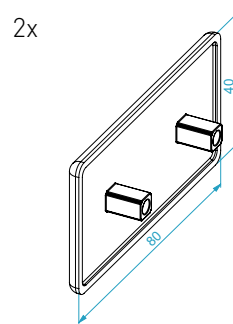
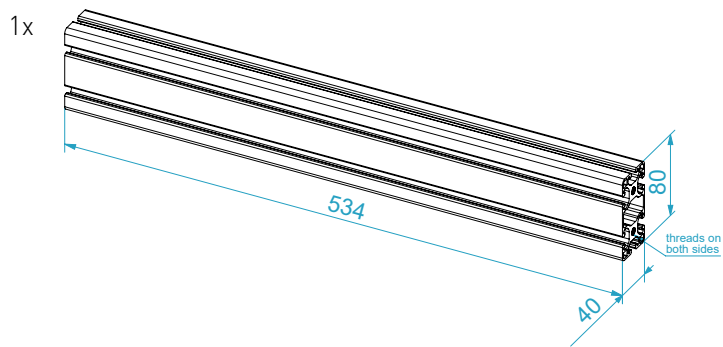
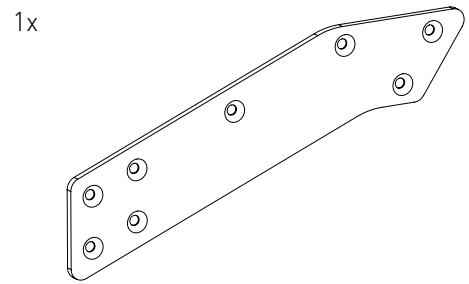
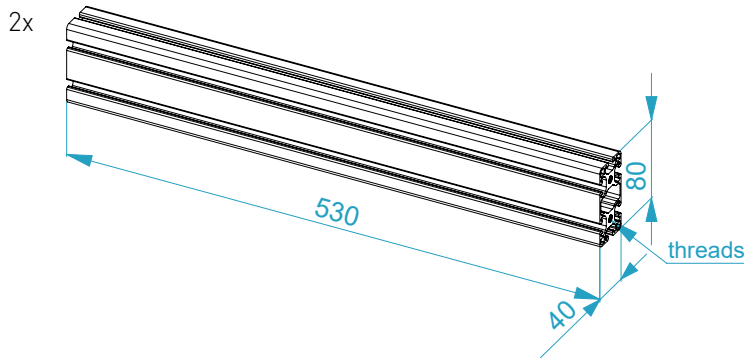
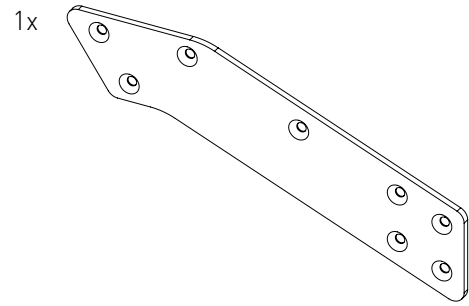
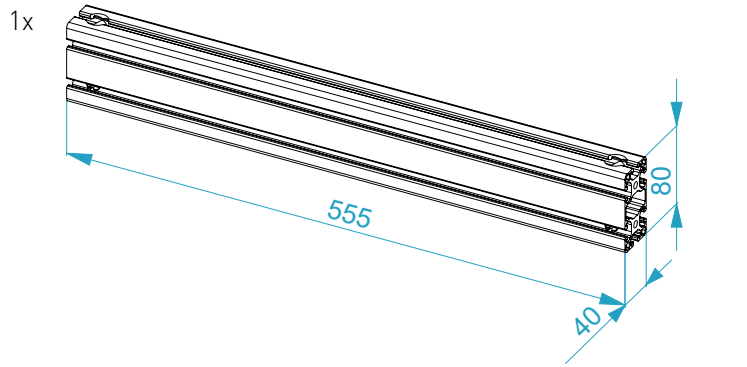

## BAG 1

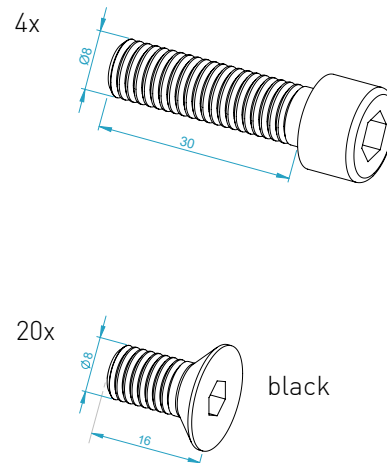
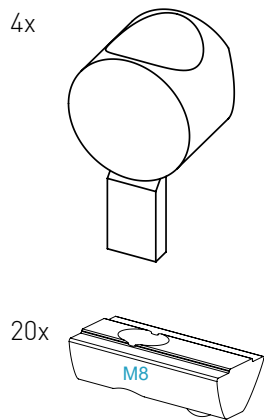

## BAG 2

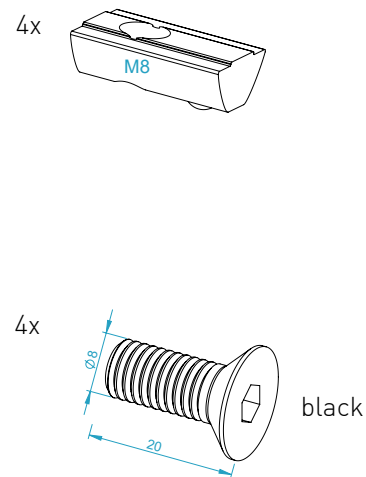
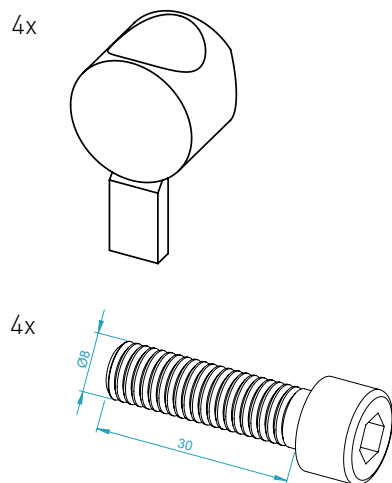

## BAG 3 with parts for yoke assembly

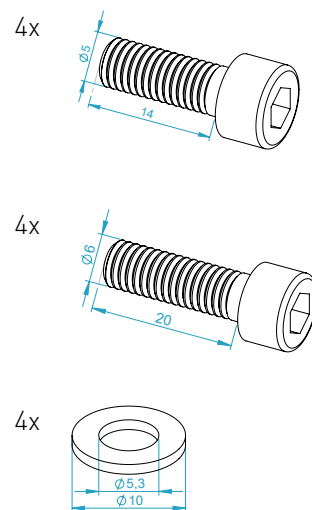
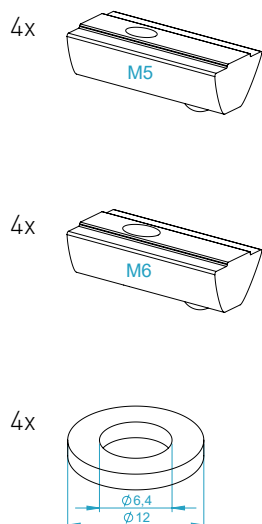

## PRE-ASSEMBLED

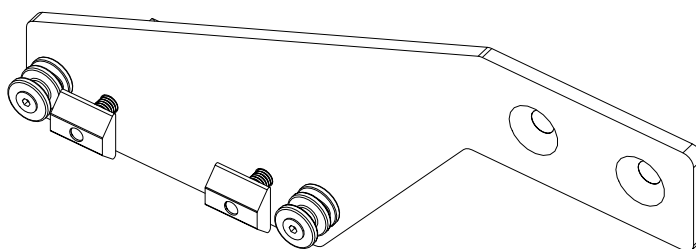
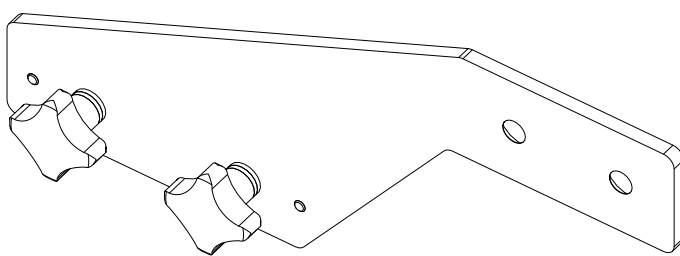

with this parts:

1x

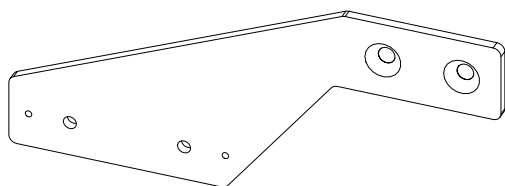

1x

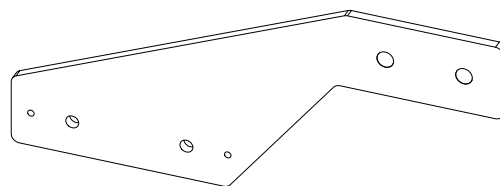

4x

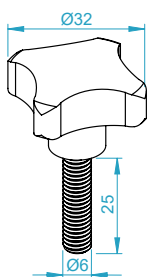

8x

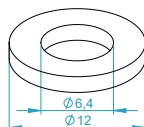

4x

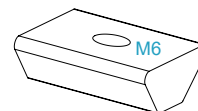

4x

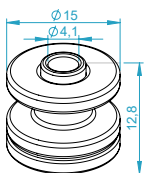

4x

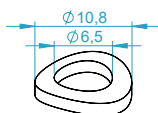

4x

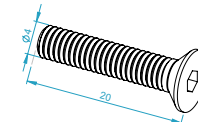

# ASSEMBLY

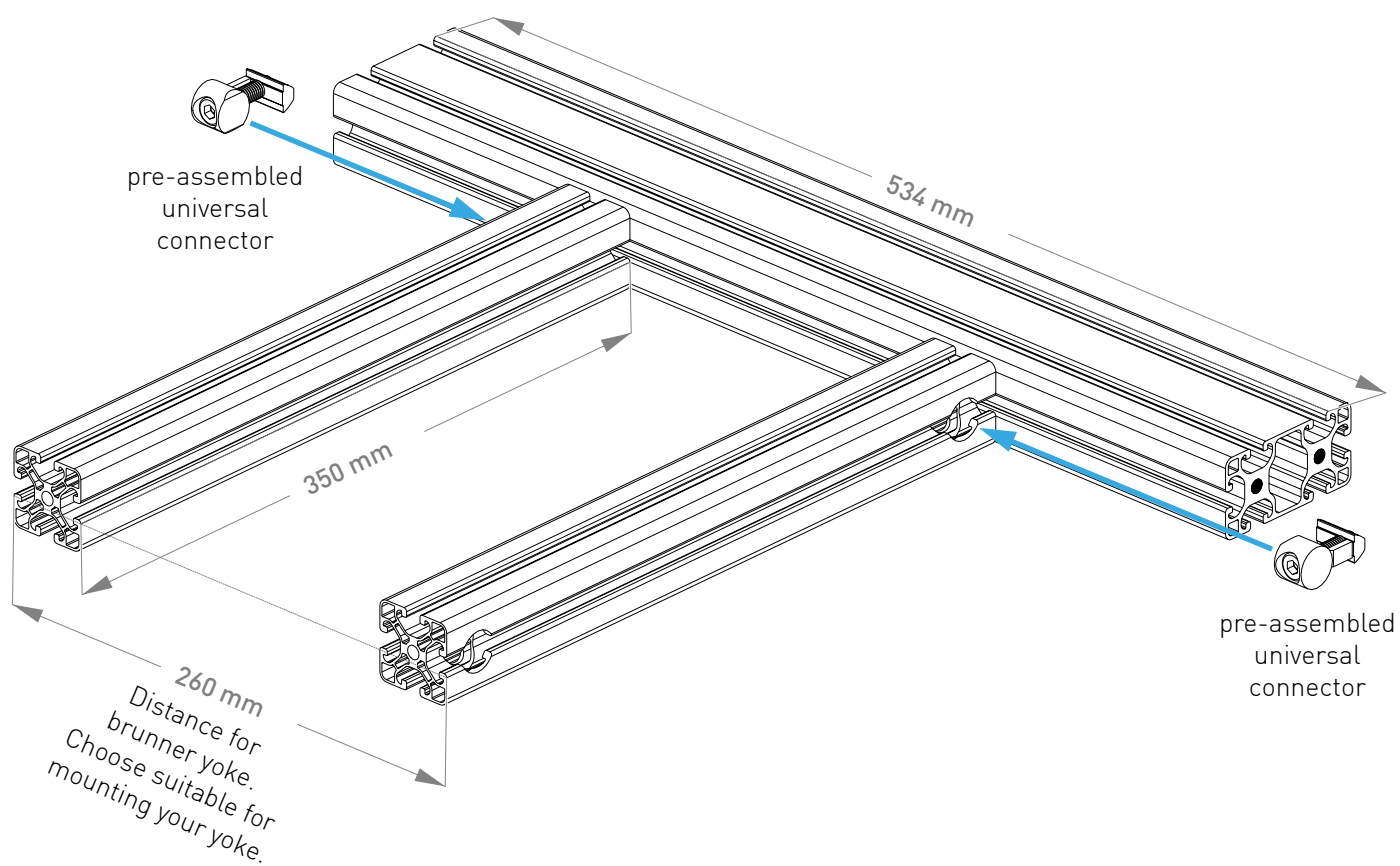
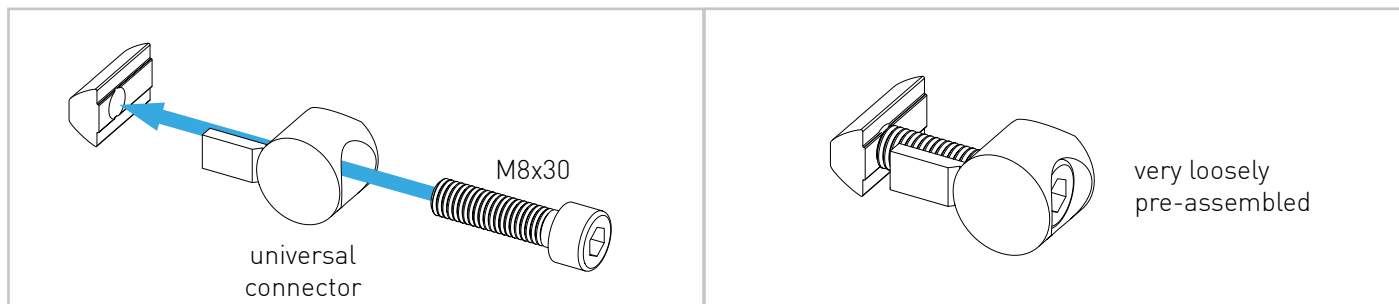

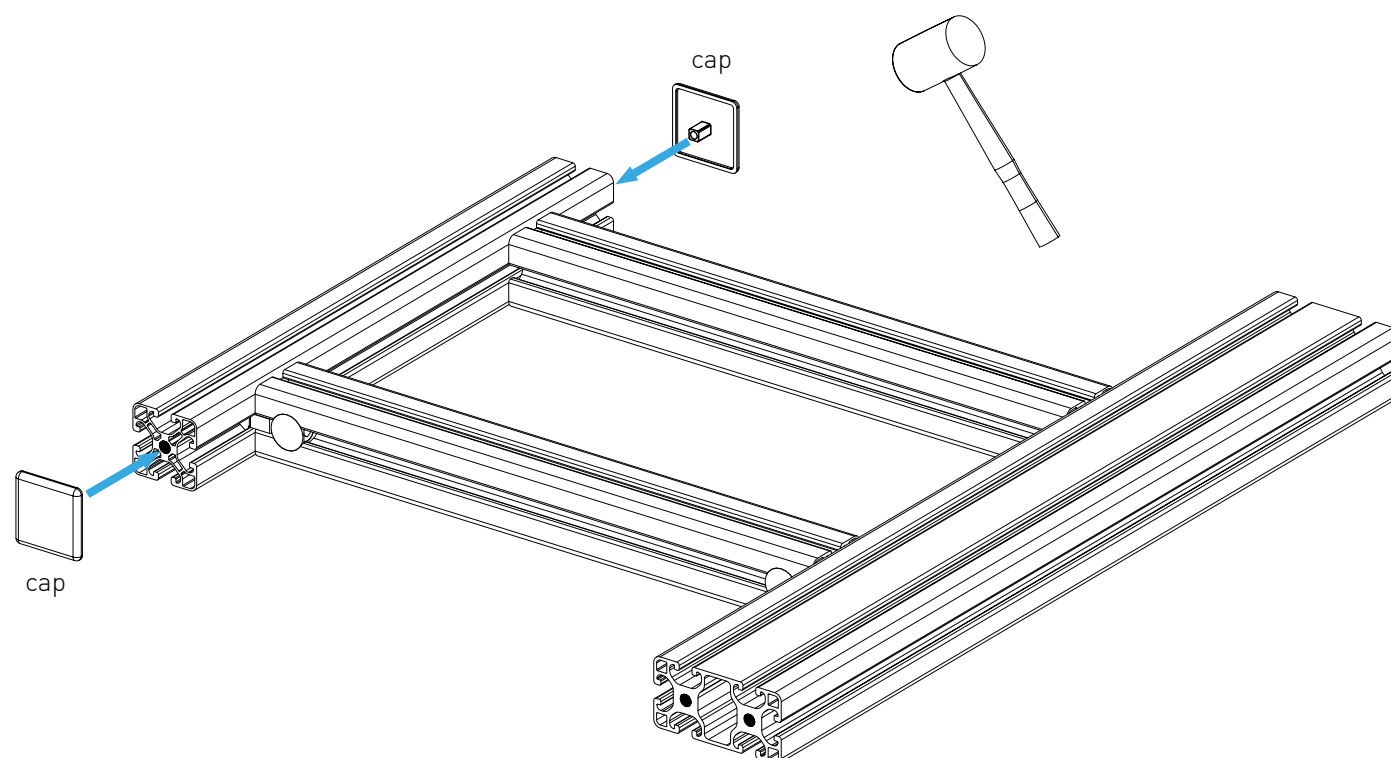
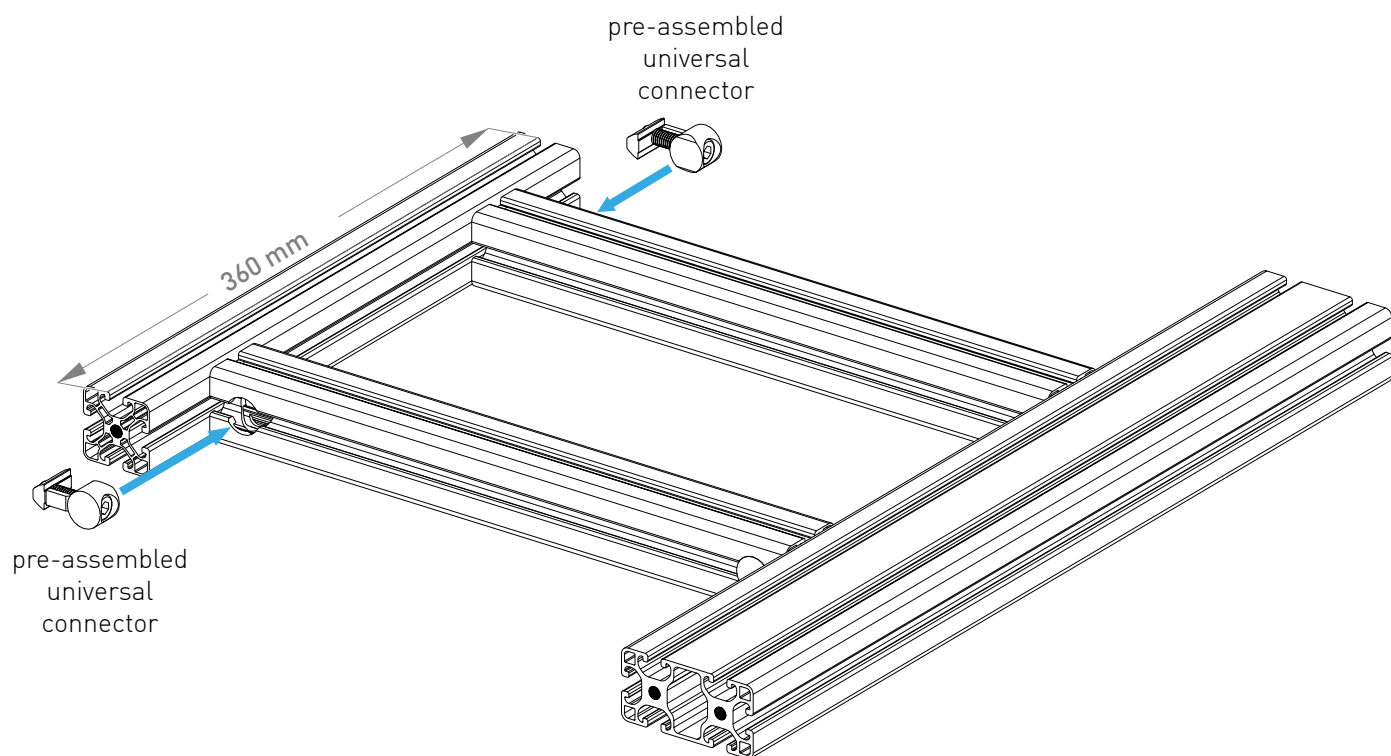

## USUALLY PRE-ASSEMBLED

2x

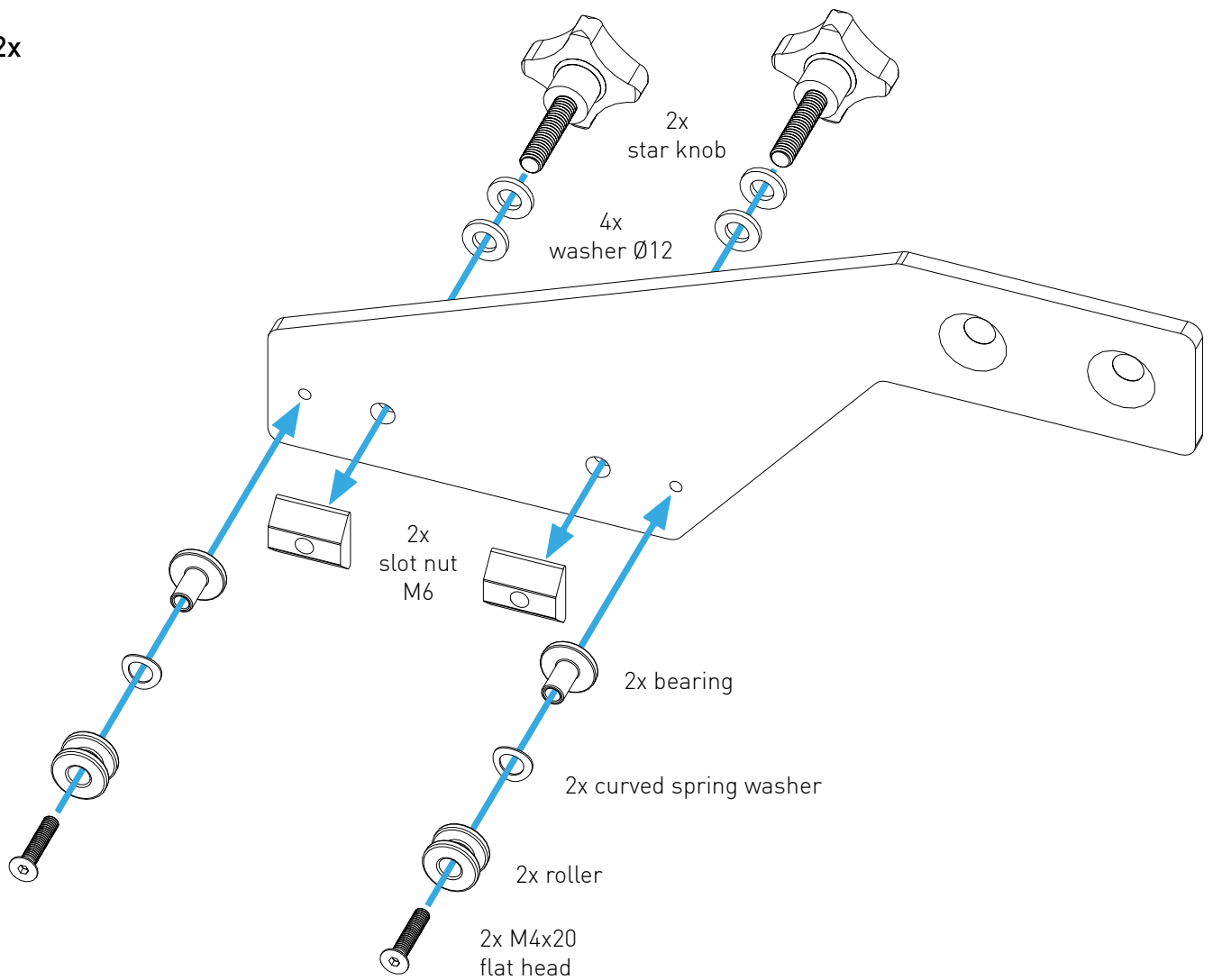

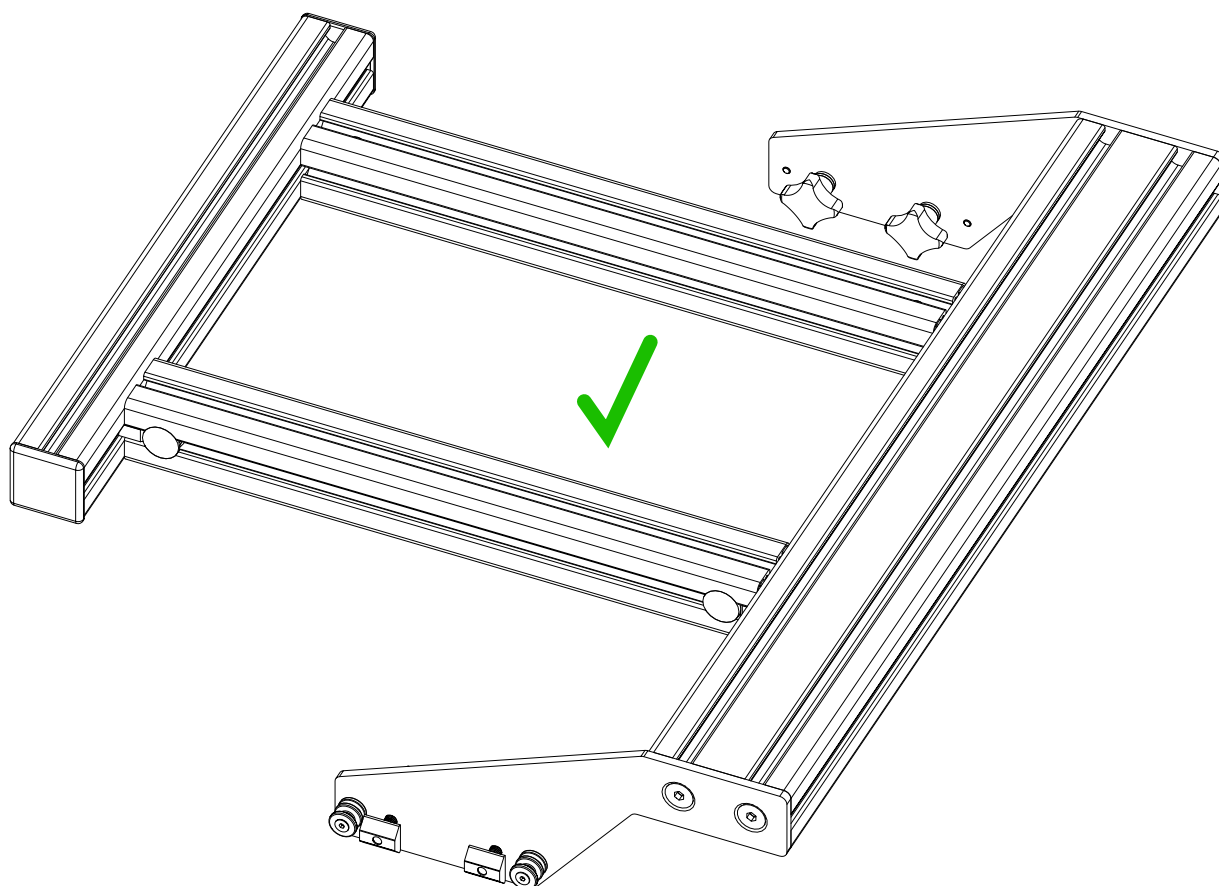
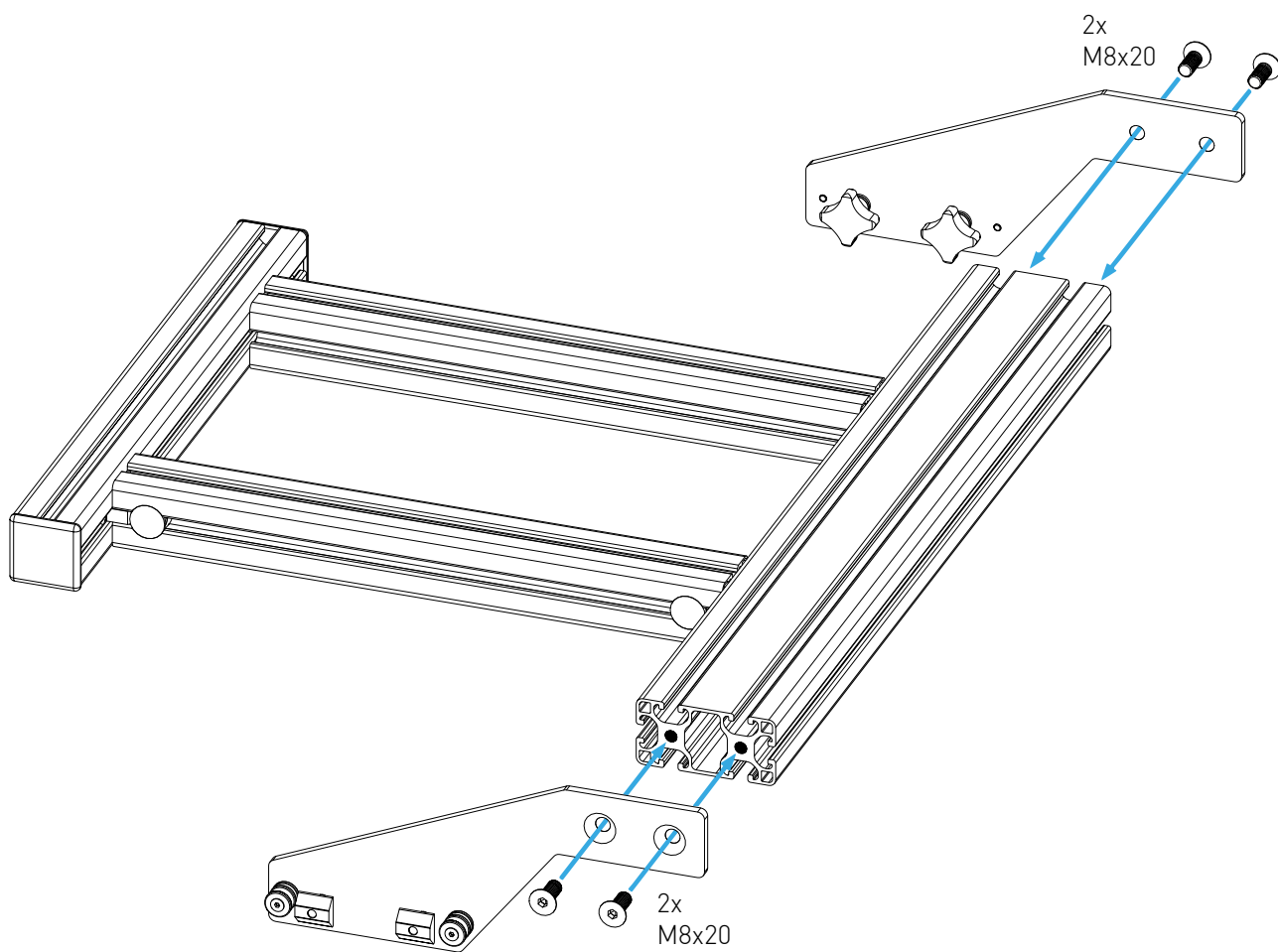



Use a plan surface  
for assembly.

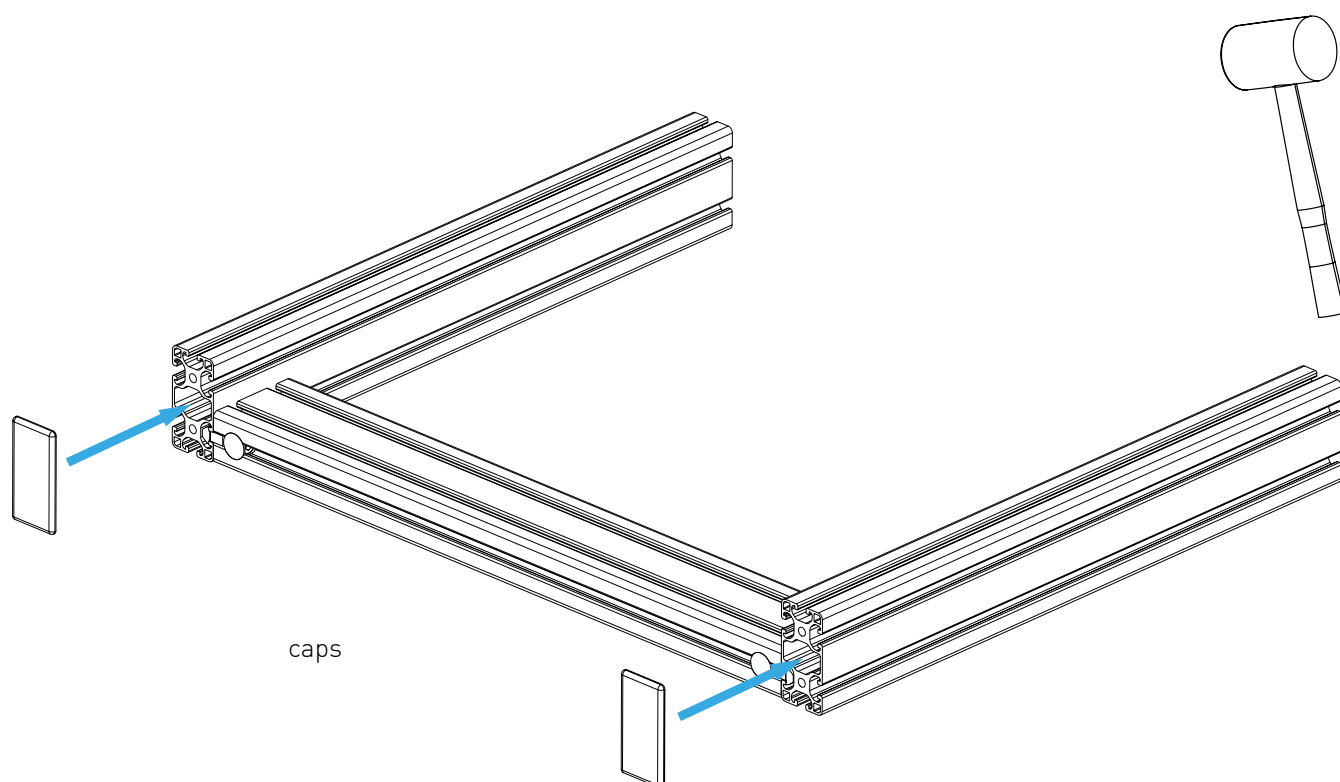
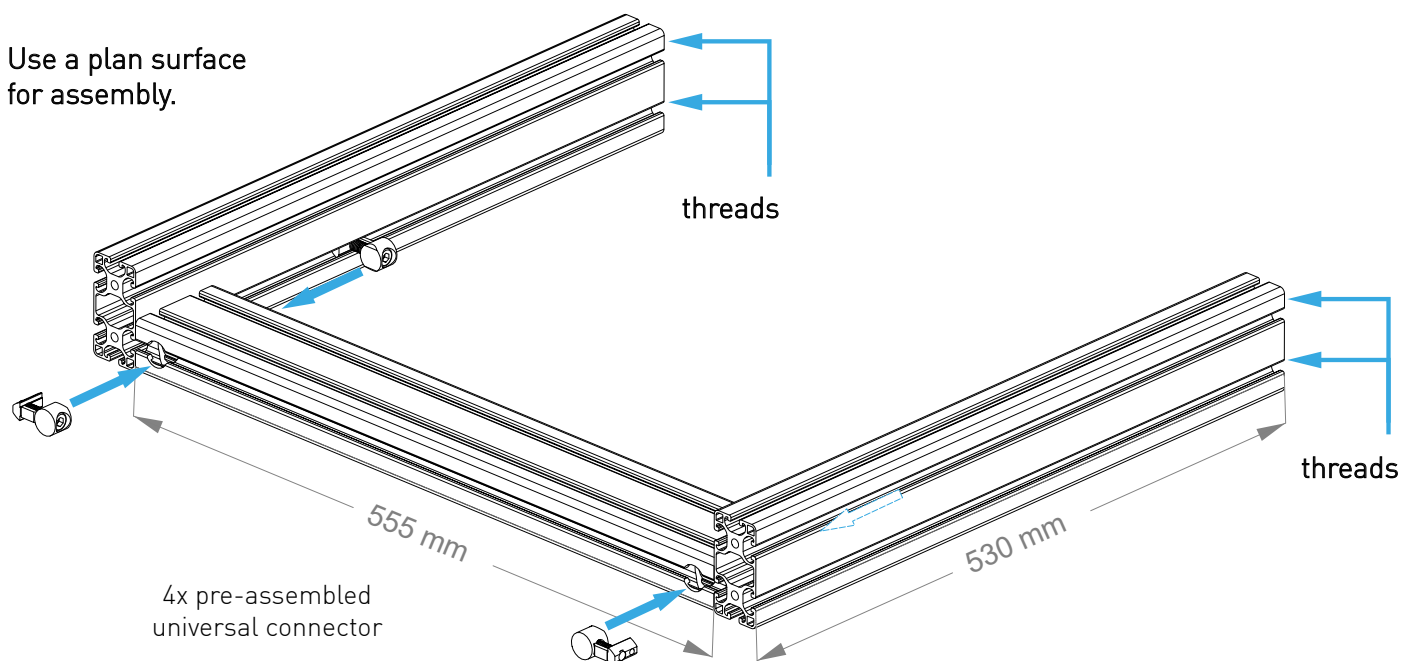

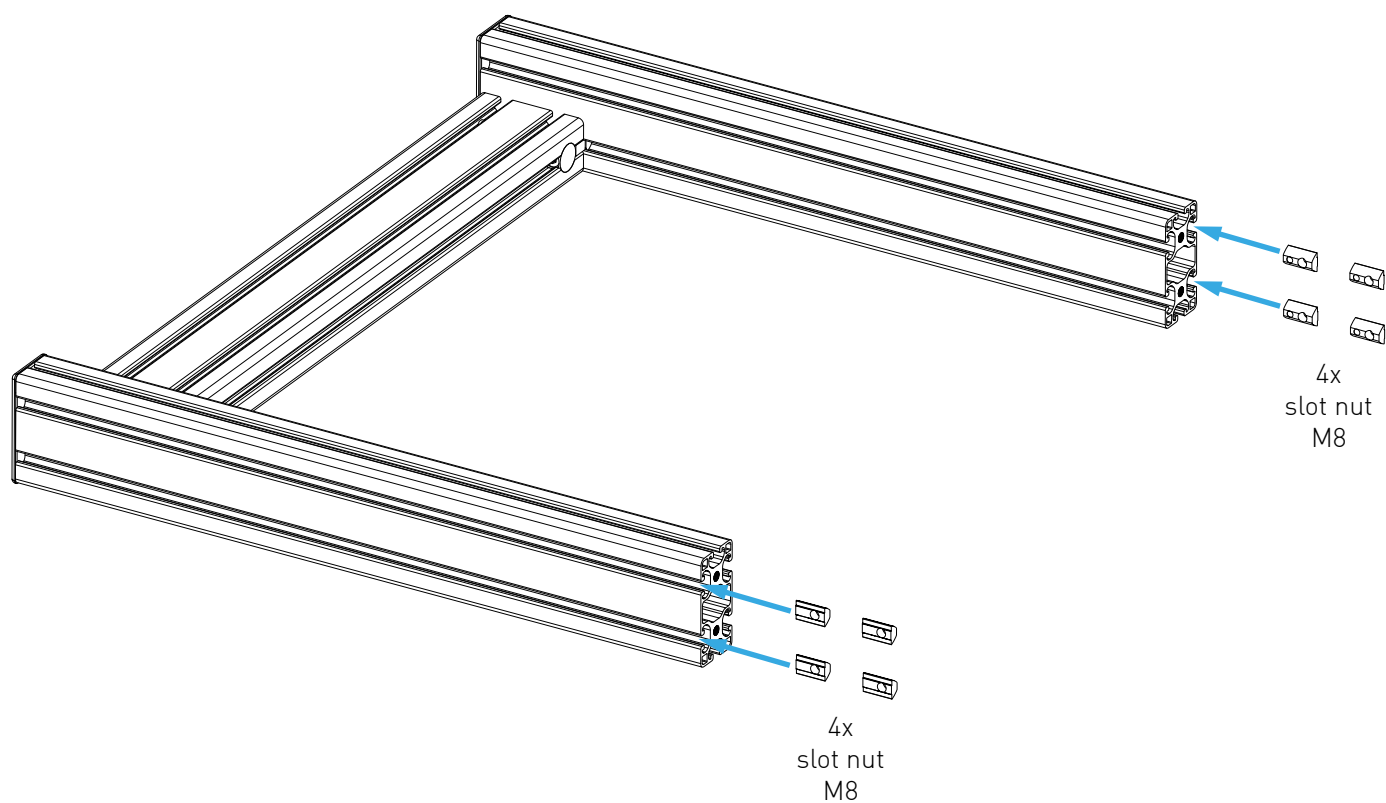

on both sides

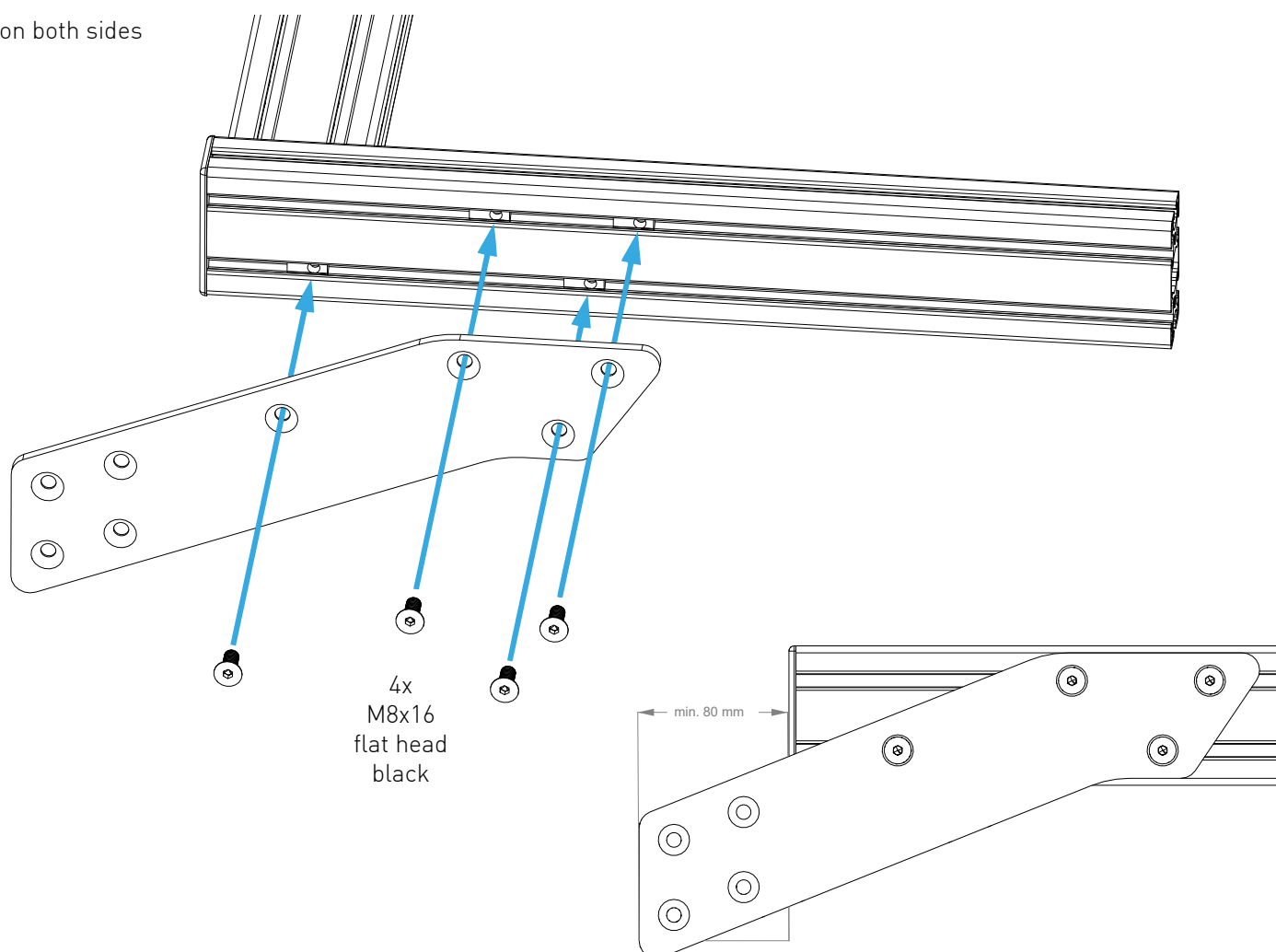

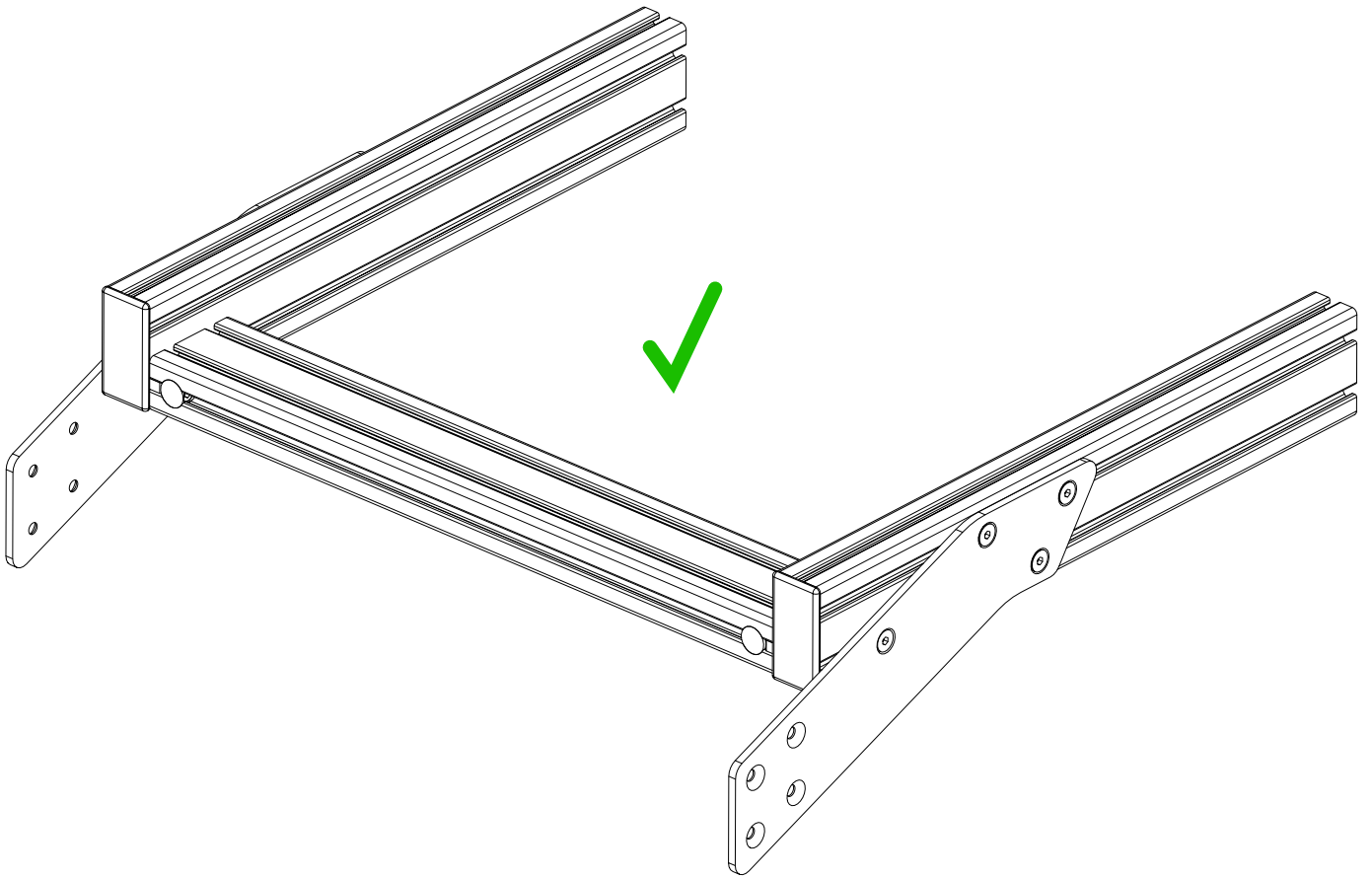

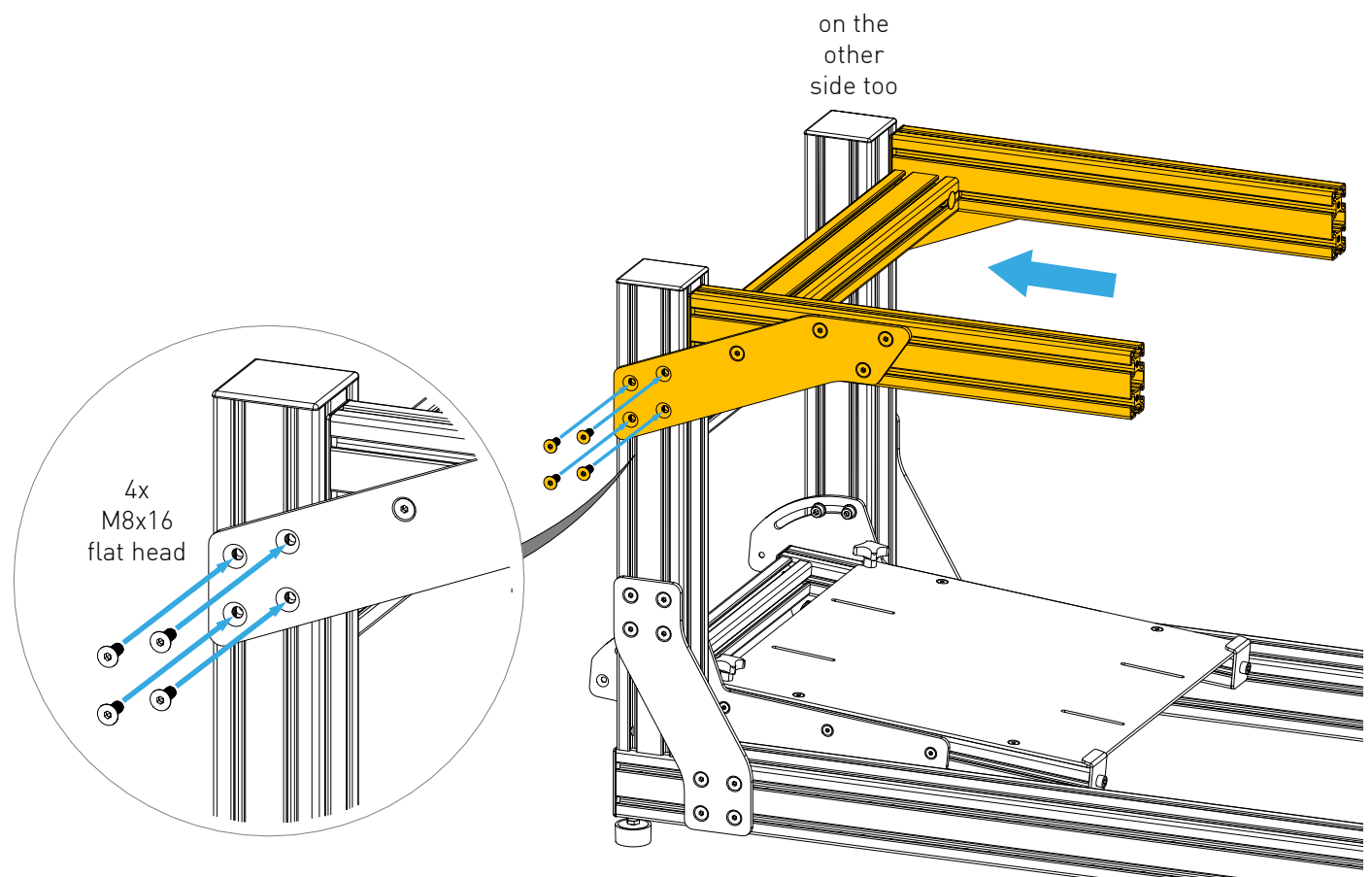
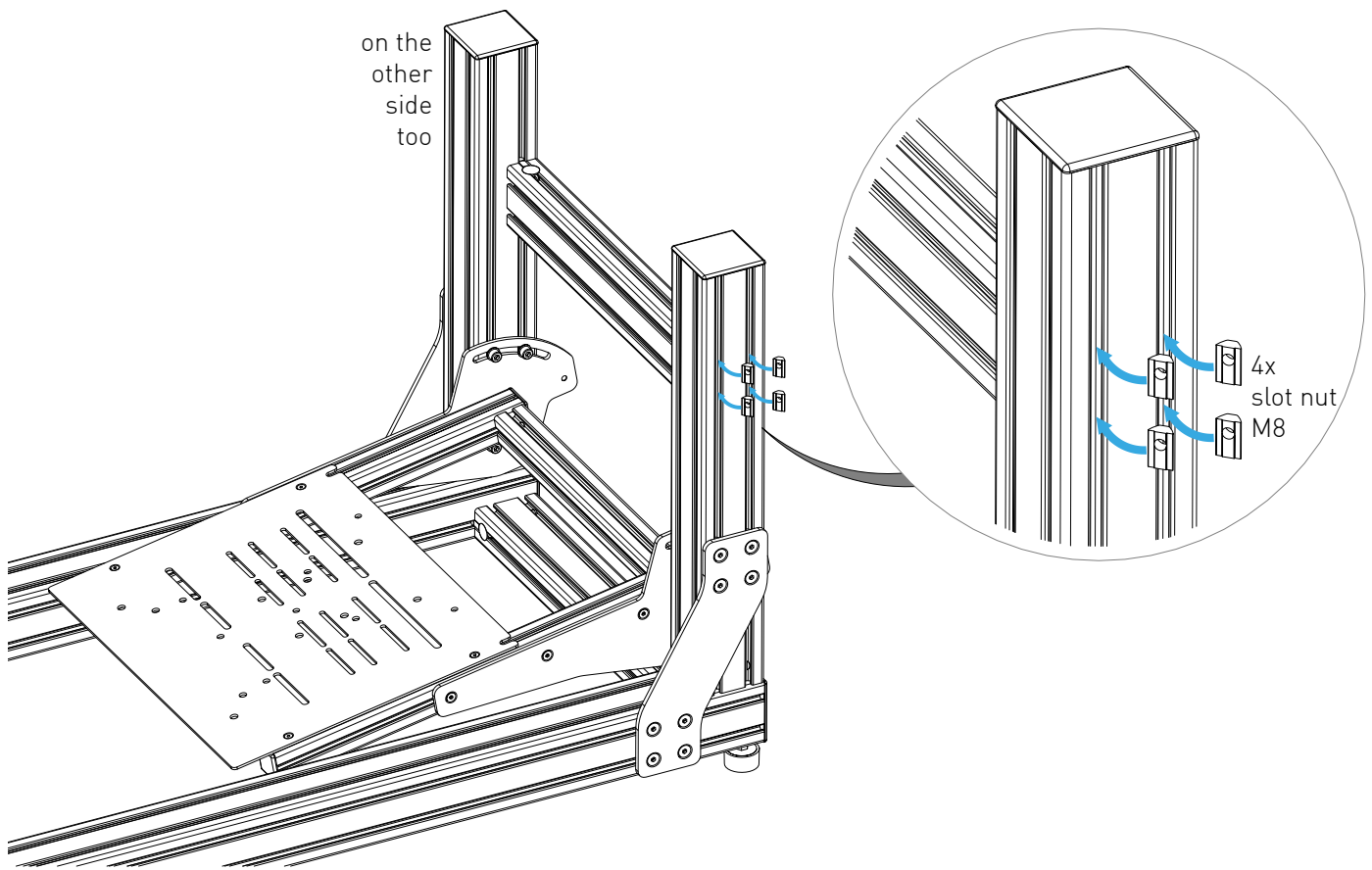

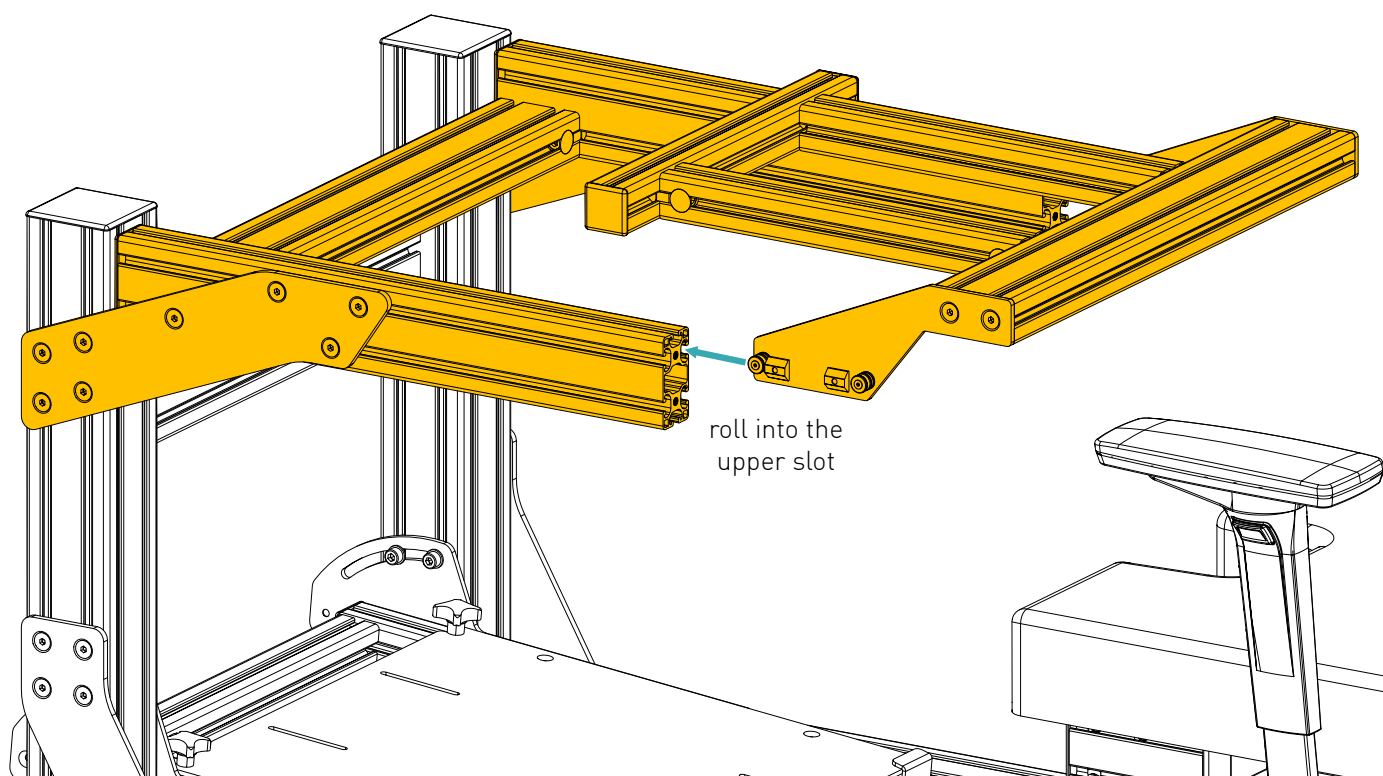

#### detail view

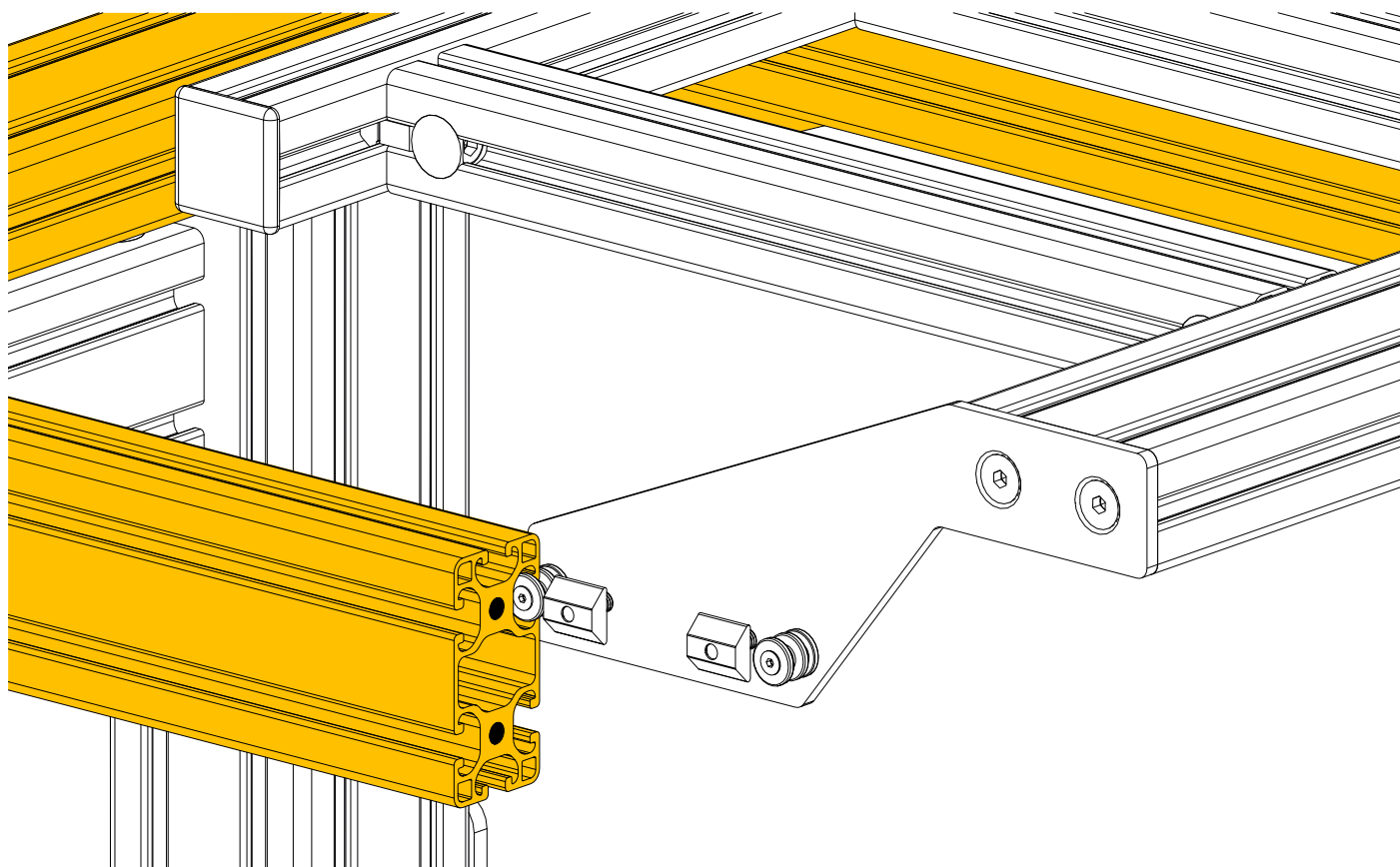

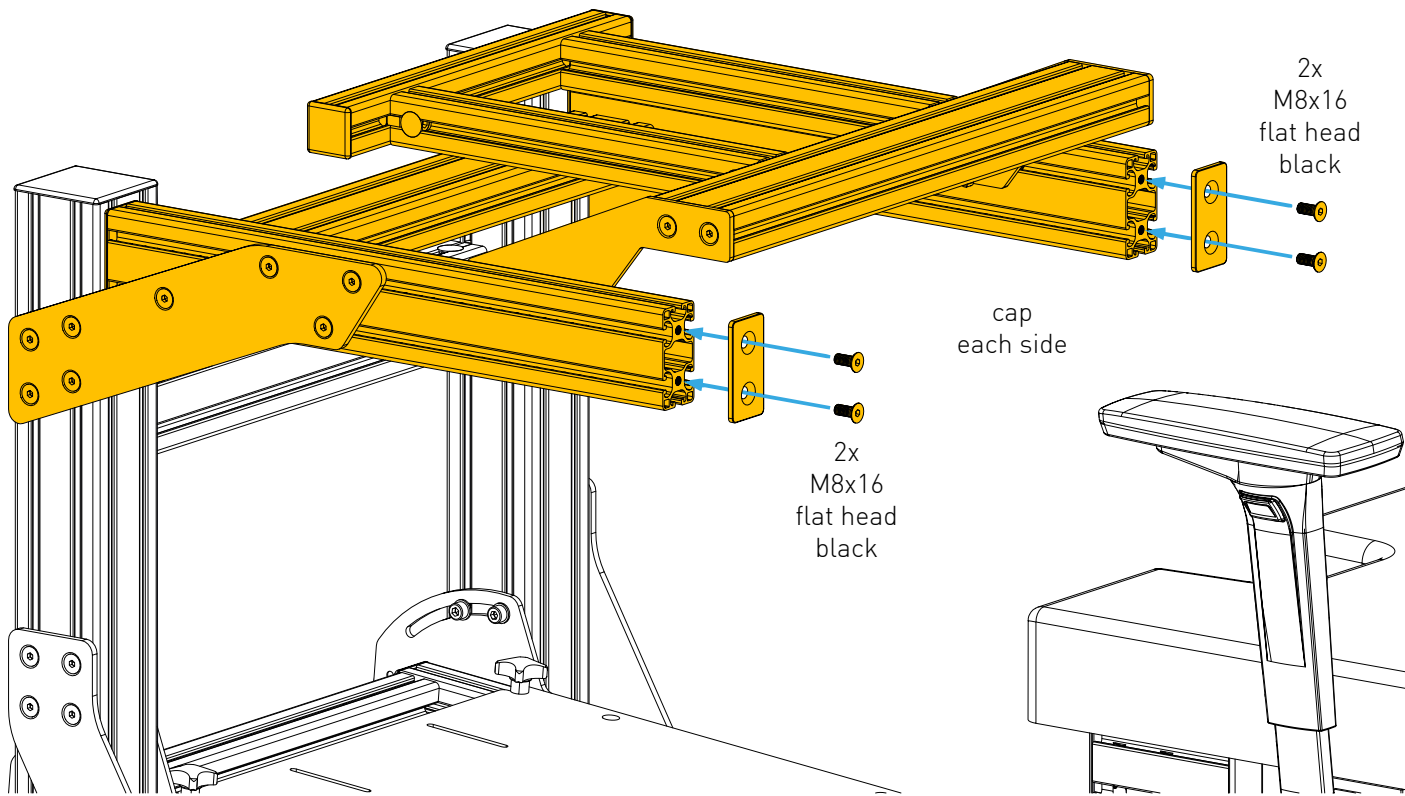

#### detail

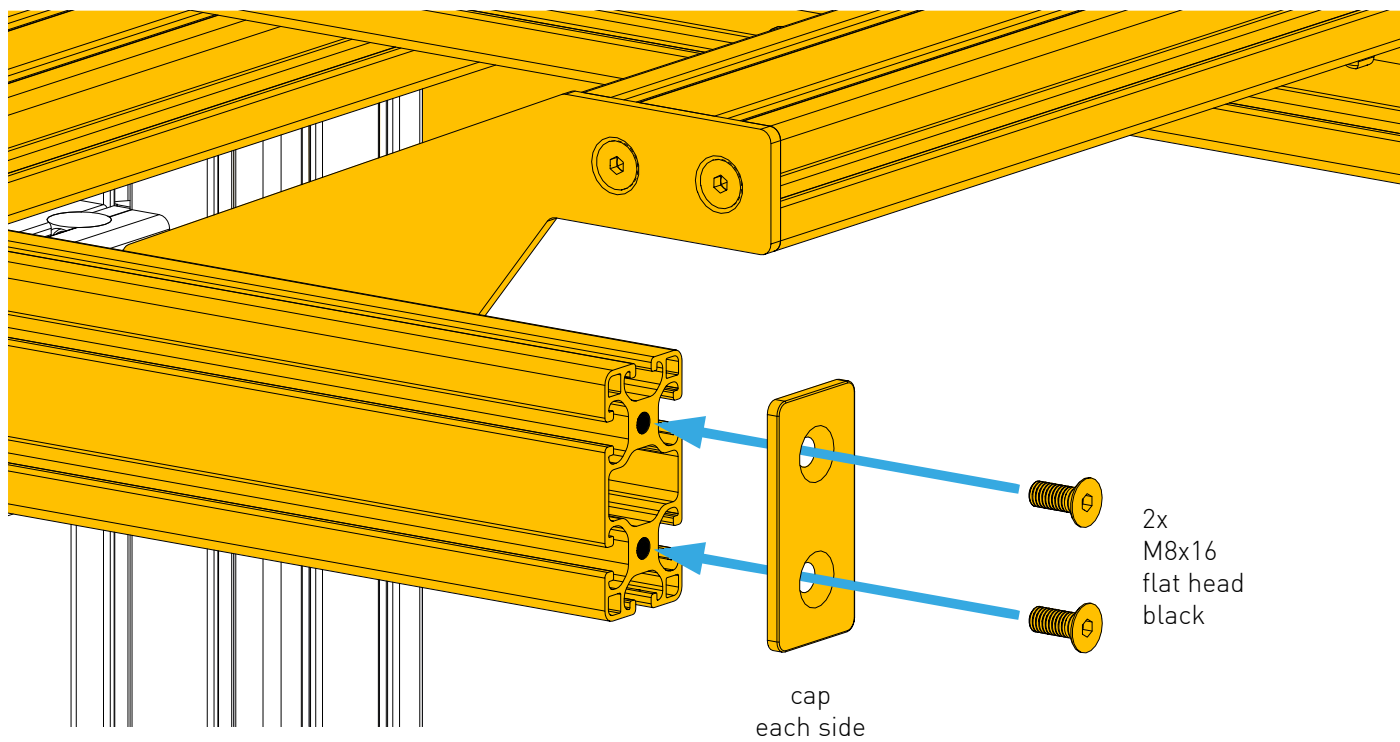

## ASSEMBLING A BRUNNER YOKE

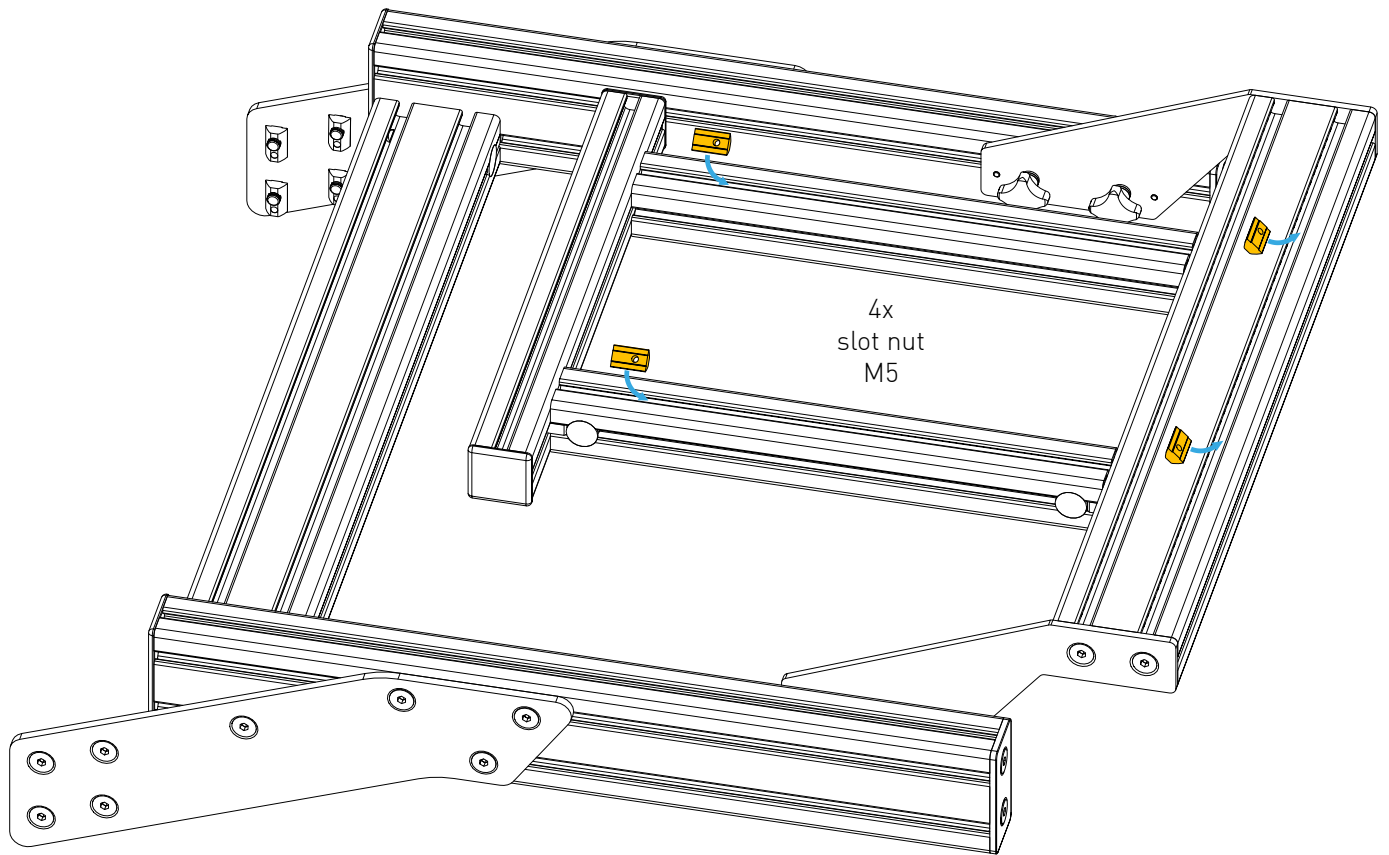

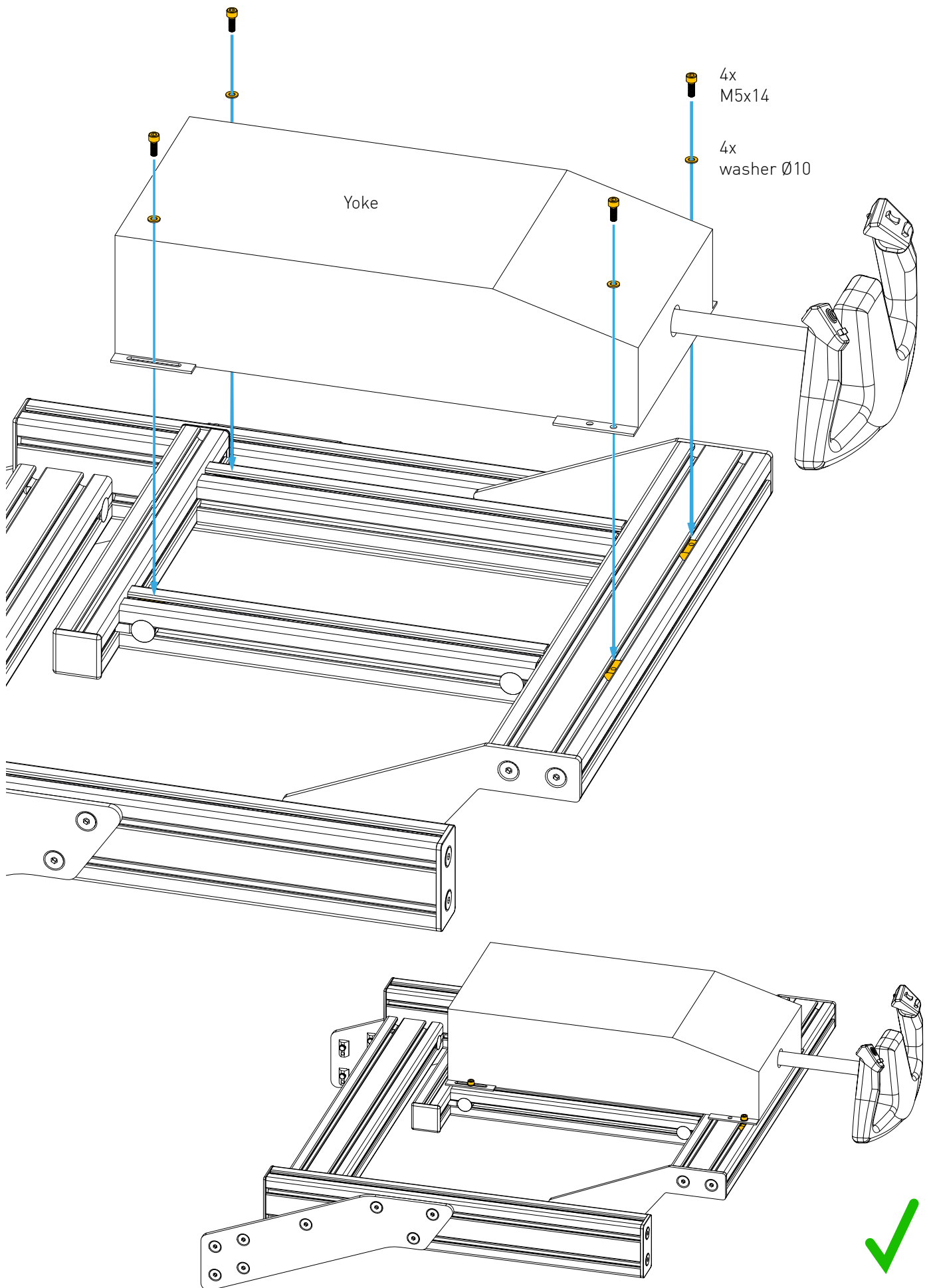



# UNIVERSAL ASSEMBLING WITH BRACKETS

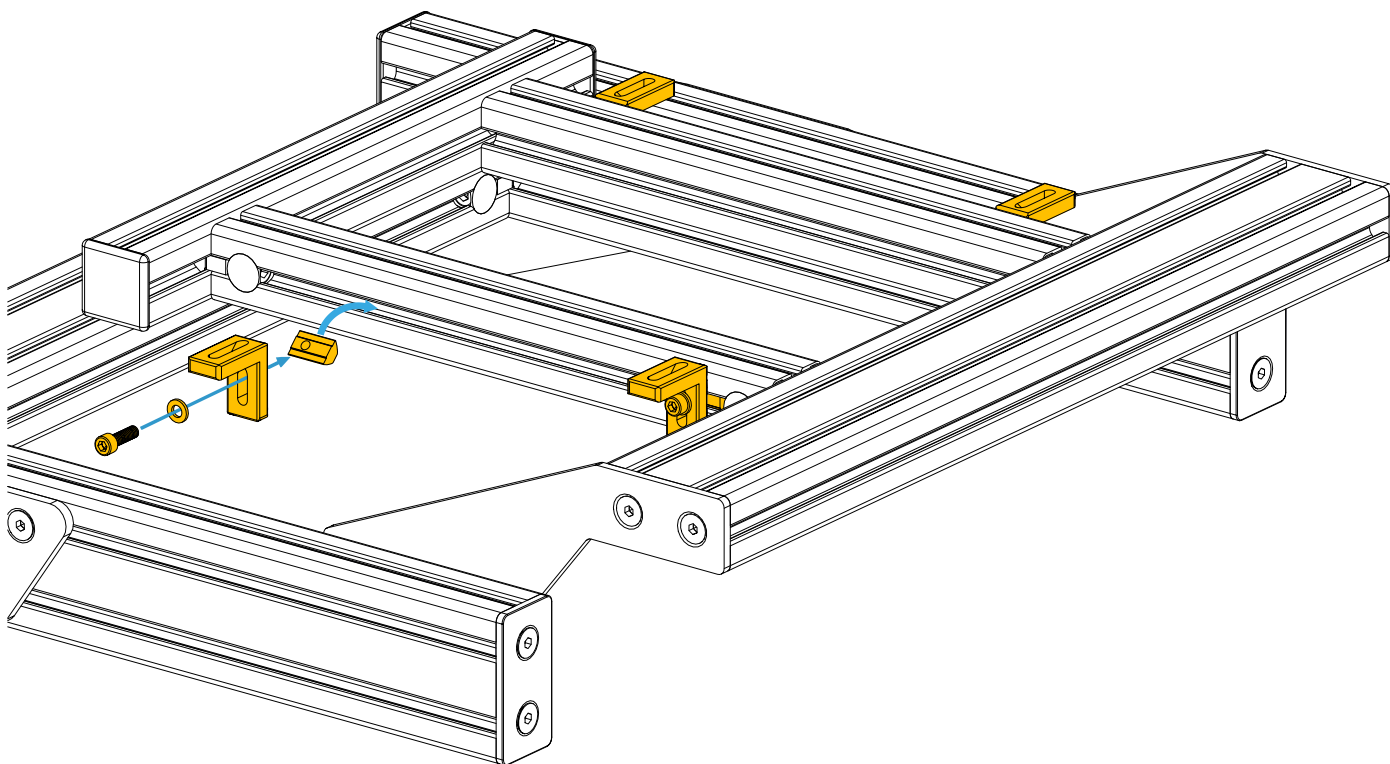

detail view

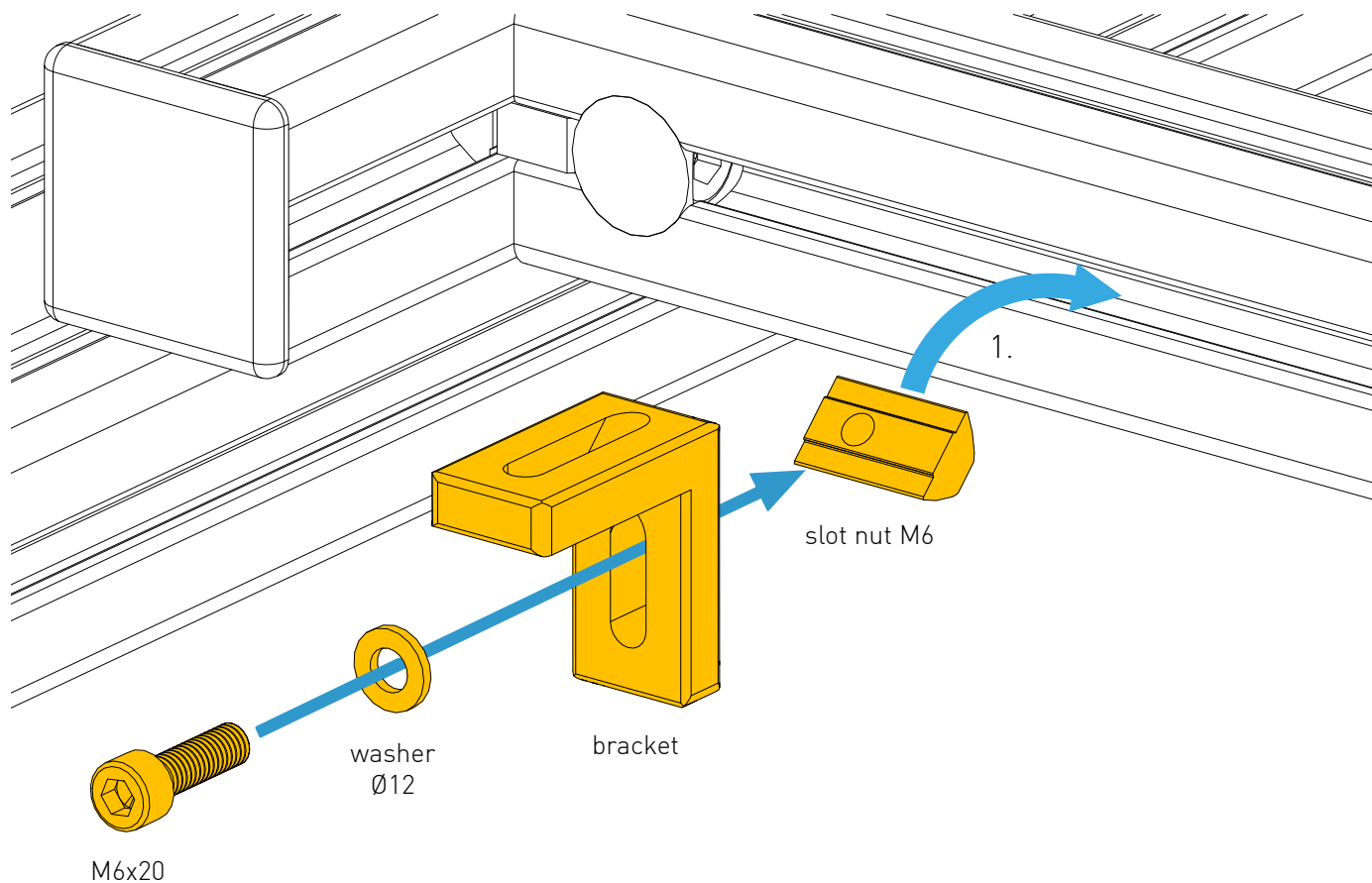

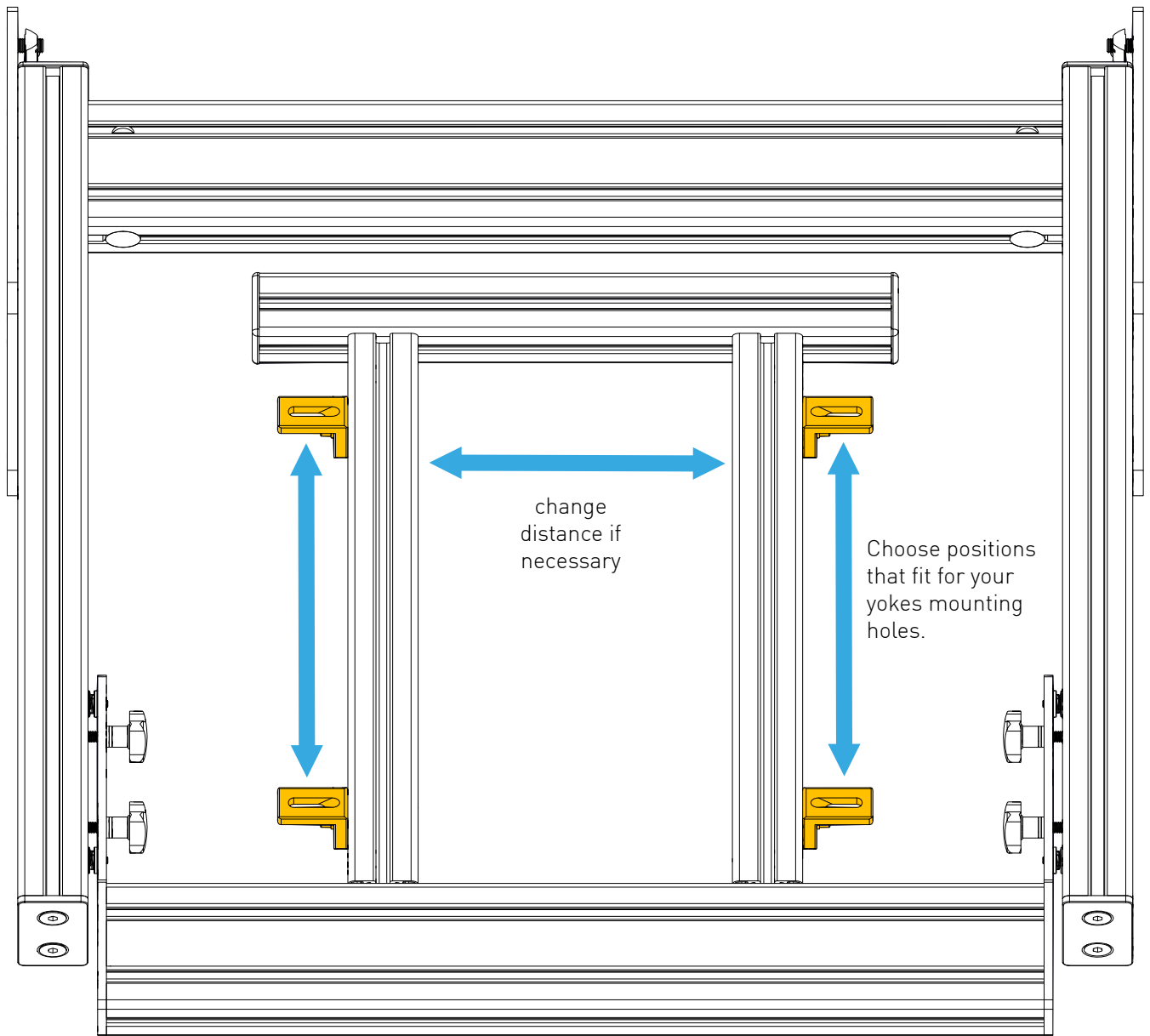

## Alternative positions for the brackets

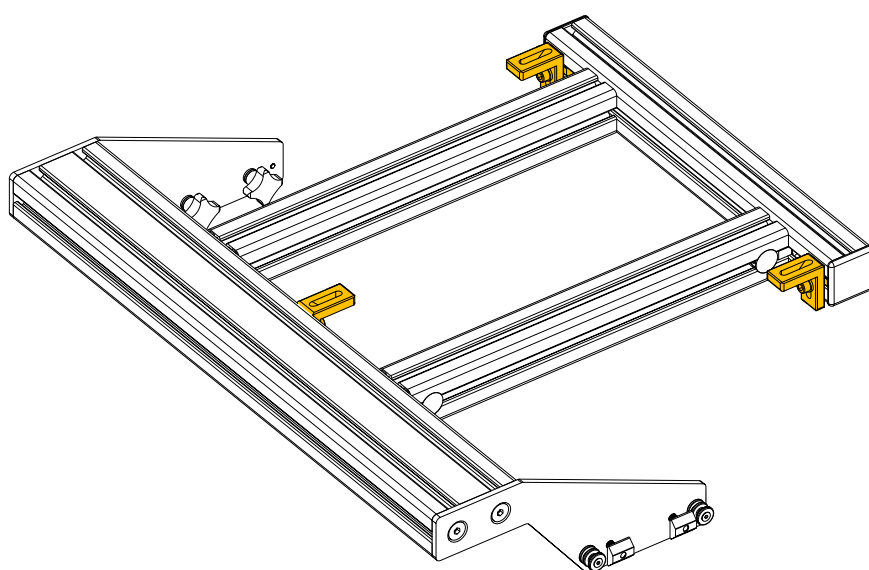
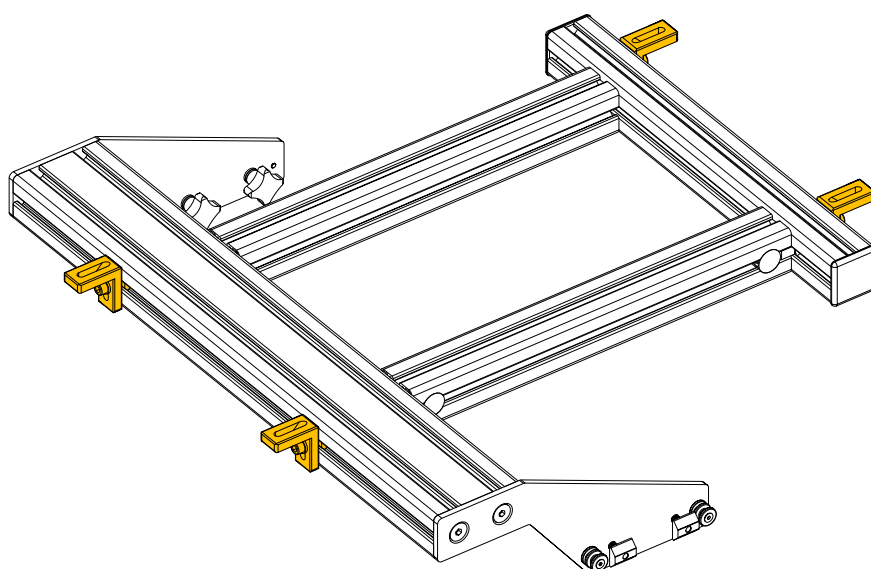
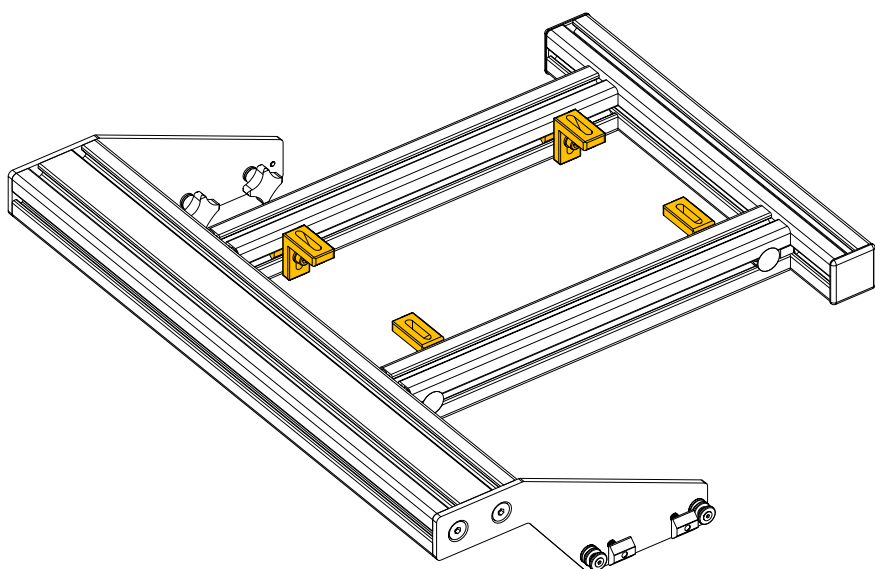

## OPERATION

Loose the red marked bolts on each side to adjust the height.

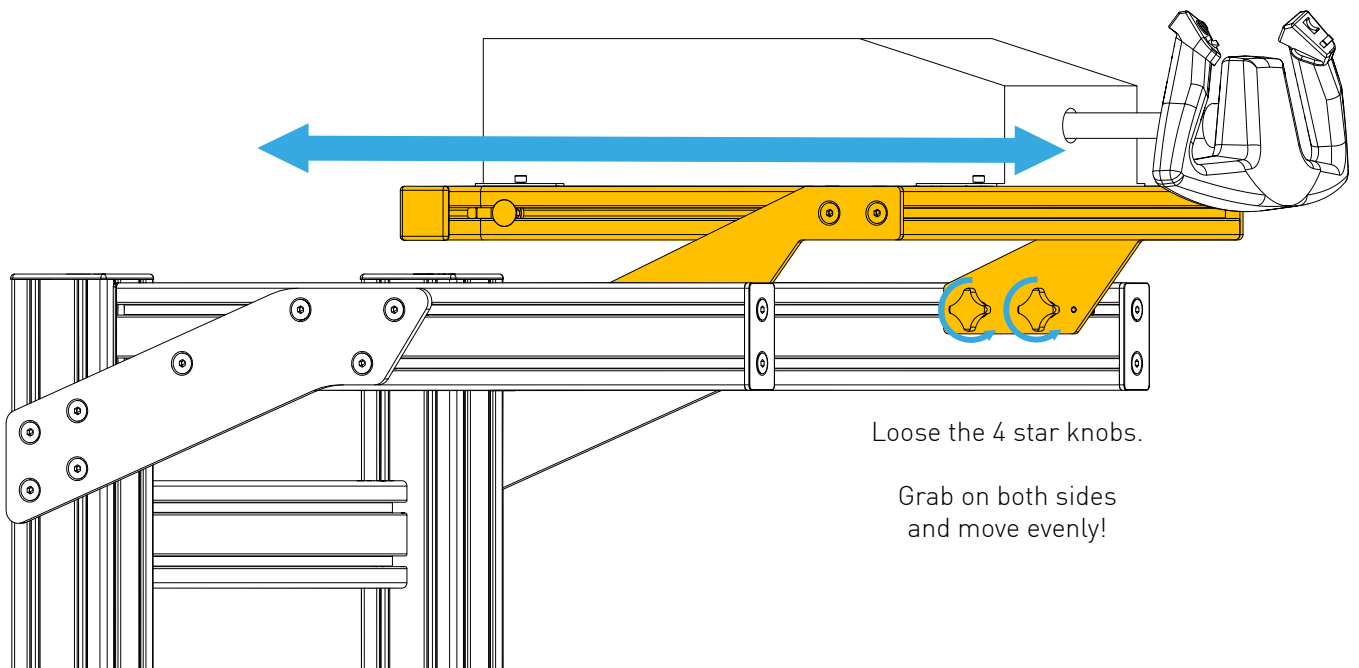
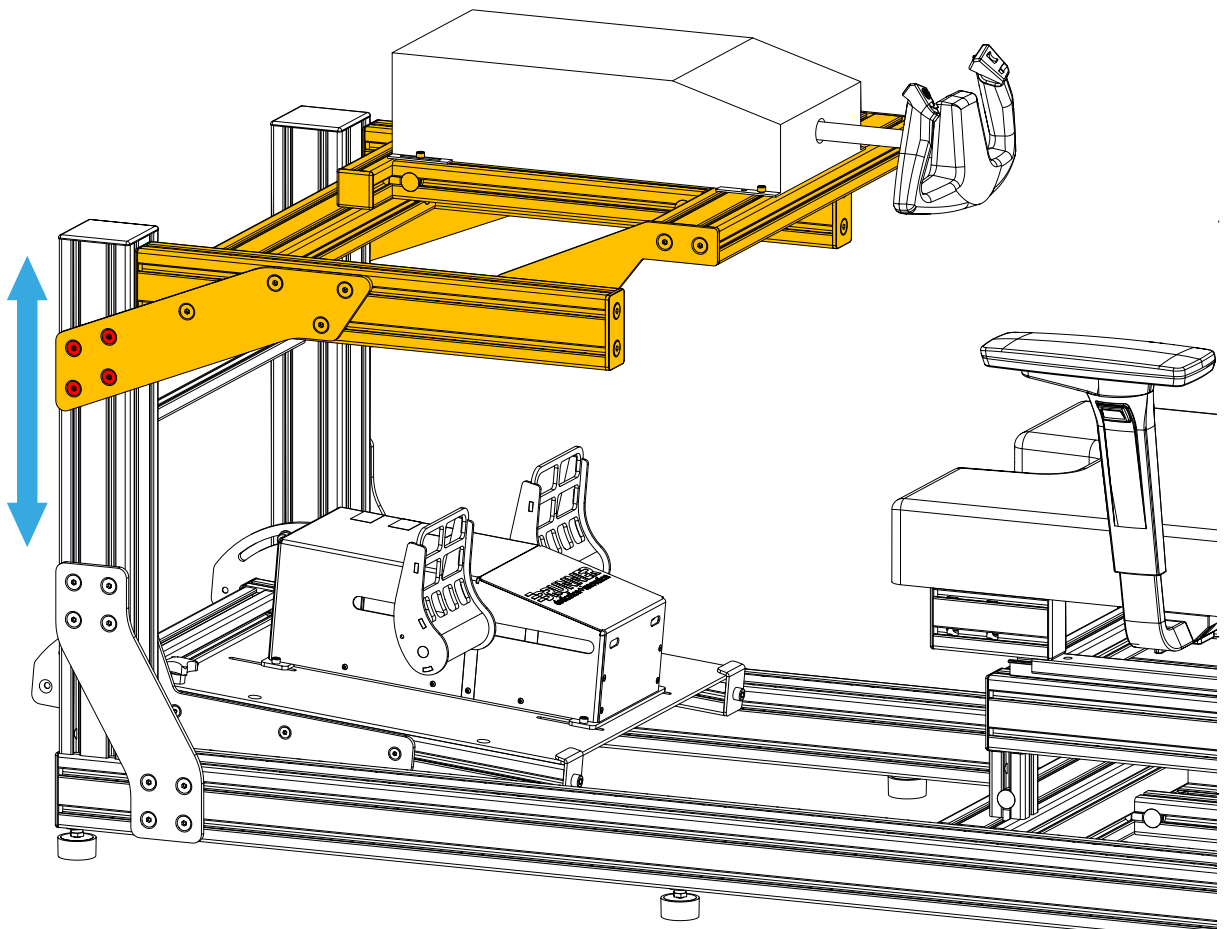

Loose the 4 star knobs.

Grab on both sides  
and move evenly!

